

vtech[®]
baby

Instruction Manual

Barnyard Adventure Playset™



INTRODUCTION

Thank you for purchasing the **Barnyard Adventure Playset™**. Enjoy the country with the **Barnyard Adventure Playset™**! Adventure awaits as little farmers open the door and let the farm **Animals** roam. Drive and press the **Tractor** to hear songs and phrases. After a long day of play, the **Tractor** and **Animals** come home to rest, stored easily in the **Barn**.



On/Off/Volume Switch

4 Animal Buttons

INCLUDED IN THE PACKAGE

- Barnyard Adventure Playset™
- Quick Start Guide



1 Barn



1 Electronic Tractor



1 Playmat



4 Plush Animals (Chicken, Duck, Cow, Horse)

WARNING

All packing materials, such as tape, plastic sheets, packaging locks, removable tags, cable ties, cords and packaging screws are not part of this toy, and should be discarded for your child's safety.

NOTE

Please save this Instruction Manual as it contains important information.

ATTENTION

Pour la sécurité de votre enfant, débarrassez-vous de tous les produits d'emballage tels que rubans adhésifs, feuilles de plastique, attaches, étiquettes et vis d'emballage. Ils ne font pas partie du jouet.

NOTE

Il est conseillé de sauvegarder ce manuel d'instructions car il comporte des informations importantes.

Unlock the packaging locks:

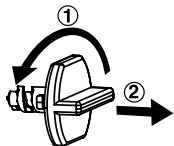

- ① Turn the packaging lock 90 degrees counterclockwise several times.
- ② Pull out and discard the packaging lock.

GETTING STARTED

Battery Removal and Installation

1. Make sure the unit is turned **Off**.
2. Locate the battery cover located on the bottom of the tractor, use a screwdriver to loosen the screw and then open the battery cover.
3. Remove the old battery by pulling up on one end of the battery.
4. Install 1 new AA (AM-3/LR6) battery following the diagram inside the battery box. (For best performance, alkaline batteries or fully charged Ni-MH rechargeable batteries are recommended.)
5. Replace the battery cover and tighten the screw to secure.

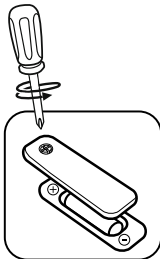

WARNING:

Adult assembly required for battery installation.
Keep batteries out of reach of children.



ATTENTION :

Les piles ou accumulateurs doivent être installés par un adulte.
Tenir les piles ou accumulateurs hors de portée des enfants.

IMPORTANT: BATTERY INFORMATION



- Insert batteries with the correct polarity (+ and -).
- Do not mix old and new batteries.
- Do not mix alkaline, standard (carbon-zinc) or rechargeable batteries.
- Only batteries of the same or equivalent type as recommended are to be used.
- Do not short-circuit the supply terminals.
- Remove batteries during long periods of non-use.
- Remove exhausted batteries from the toy.
- Dispose of batteries safely. Do not dispose of batteries in fire.

RECHARGEABLE BATTERIES

- Remove rechargeable batteries (if removable) from toy before charging.
- Rechargeable batteries are only to be charged under adult supervision.
- Do not charge non-rechargeable batteries.

PRODUCT FEATURES

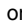
1. On/Off/Volume Switch

To turn the unit **On**, slide the **On/Off/Volume Switch** to the Low volume  or High volume  position. You will hear a phrase and a song. To turn the unit **Off**, slide the **On/Off/Volume Switch** to the **Off**  position.

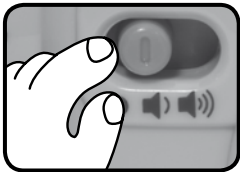

2. Automatic Shut-Off

To preserve battery life, the Tractor will automatically power down after approximately 35 seconds without input. The unit can be turned **On** again by pressing any button.

NOTE

If the unit powers down or the light fades out during play, please install a new set of batteries.

ACTIVITIES

1. 4 Animal Buttons

Press the four **Animal Buttons** to hear animal sounds, farm phrases, sing-along songs and melodies. The light will flash with the sounds.



2. Wheels

Push the **Tractor** forward to hear barnyard phrases and sounds. The light will flash with the sounds.



MELODIES

1. Little Miss Muffet
2. Bingo
3. The Entertainer
4. Yankee Doodle
5. Wheels on the Bus
6. Hey Diddle Diddle
7. Hickory Dickory Dock
8. Itsy Bitsy Spider
9. One Man Went to Mow a Meadow
10. Little Bo-Peep
11. Three Little Kittens
12. Mary Had a Little Lamb
13. Here We Go Round the Mulberry Bush
14. Oats, Peas, Beans, and Barley Grow
15. Teddy Bears' Picnic

SONG LYRICS

Song 1

Welcome friends to our farm.
Where every day is fun.
Duck and chicken, horse and cow.
Let's play all day long.

Song 2

A beep-beep, a too-toot.
Let's go on the tractor,
Have lots of fun, playing together.
Beep-beep, toot-toot-toot.

Song 3

The animals like to play on the farm.
Laughing, hopping, running all day.

CARE & MAINTENANCE

1. Keep the **Tractor** clean by wiping it with a slightly damp cloth.
2. Keep the **Tractor** out of direct sunlight and away from any direct heat sources.
3. Remove the battery if the **Tractor** will not be in use for an extended period of time.
4. Do not drop the **Tractor** on hard surfaces and do not expose the unit to moisture or water.
5. The plush **Barn, Chicken, Cow, Horse** and **Playmat** are machine washable. The plush **Duck** is not machine washable. Please follow the care instructions on the tag.

TROUBLESHOOTING

If for some reason the unit stops working or malfunctions, please follow these steps:

1. Turn the **Tractor Off**.
2. Interrupt the power supply by removing the battery.
3. Let the **Tractor** stand for a few minutes, then replace the battery.
4. Turn the **Tractor On**. The unit should now be ready to use again.
5. If the **Tractor** still does not work, install a new set of battery.

IMPORTANT NOTE:

If the problem persists, please contact our **Consumer Services Department** at **1-800-521-2010** in the U.S. or **1-877-352-8697** in Canada, or by going to our website at **vtechkids.com** and filling out our **Contact Us** form located under the **Customer Support** link. Creating and developing VTech products is accompanied by a responsibility that we take very seriously. We make every effort to ensure the accuracy of the information, which forms the value of our products. However, errors sometimes can occur. It is important for you to know that we stand behind our products and encourage you to contact us with any problems and/or suggestions that you might have. A service representative will be happy to help you.

NOTE

This equipment has been tested and found to comply with the limits for a Class B digital device, pursuant to Part 15 of the FCC Rules. These limits are designed to provide reasonable protection against harmful interference in a residential installation. This equipment generates, uses and can radiate radio frequency energy and, if not installed and used in accordance with the instructions, may cause harmful interference to radio communications. However, there is no guarantee that interference will not occur in a particular installation. If this equipment does cause harmful interference to radio or television reception, which can be determined by turning the equipment off and on, the user is encouraged to try to correct the interference by one or more of the following measures:

- Reorient or relocate the receiving antenna.
- Increase the separation between the equipment and receiver.
- Connect the equipment into an outlet on a circuit different from that to which the receiver is connected.
- Consult the dealer or an experienced radio/TV technician for help.

CAUTION

Changes or modifications not expressly approved by the party responsible for compliance could void the user's authority to operate the equipment.

Supplier's Declaration of Conformity

47 CFR § 2.1077 Compliance Information

Trade Name:	VTech®
Model:	5746
Product Name:	Barnyard Adventure Playset™
Responsible Party:	VTech Electronics North America, L.L.C.
Address:	1156 W. Shure Drive, Suite 200 Arlington Heights, IL 60004
Website:	vtechkids.com

THIS DEVICE COMPLIES WITH PART 15 OF THE FCC RULES. OPERATION IS SUBJECT TO THE FOLLOWING TWO CONDITIONS: (1) THIS DEVICE MAY NOT CAUSE HARMFUL INTERFERENCE, AND (2) THIS DEVICE MUST ACCEPT ANY INTERFERENCE RECEIVED, INCLUDING INTERFERENCE THAT MAY CAUSE UNDESIRED OPERATION.
CAN ICES-003(B)/NMB-003(B)

**Visit our website for more
information about our products,
downloads, resources and more.**

vtechkids.com
vtechkids.ca

Read our complete warranty policy online at
vtechkids.com/warranty
vtechkids.ca/warranty

